iredale pedersen hook architects



Yagan Square, Perth City Link. With Lyons Architects

PRACTICE PROFILE

iredale pedersen hook architects is an internationally acclaimed design practice based in Perth and Melbourne, Australia.

The studio is renowned for its innovative approach across a very broad range of projects that are underpinned by critical thinking, stakeholder engagement and comprehensive project research.

Actively led by Founding Directors Adrian, Finn and Martyn, each with over 25 years of experience, the studio is driven by design excellence and is passionate about how architecture can make a positive impact on people's lives and contribute to Australian communities, towns and cities.

Since formation in 1999, iredale pedersen hook architects has created an expansive and significant body of work throughout Australia. Working in urban, regional and remote locations, each of our projects embodies a unique design response to the landscape and to the context it occupies.

We are motivated by a belief that all people should have access to excellent affordable design in their homes, workplaces, schools, recreational and cultural precincts and have built a reputation for delivering projects with a focus of triple-bottom-line sustainable design - that is, environmental, social and economic sustainability.

Our architecture is drawn from a landscape that is dominated by the horizon. In Australia the desert and the ocean operate as constant counterpoints to the occupation of land by built objects and our work shares an understanding of landscape within the pragmatics of context. We reject the idea of a 'signature style' to our architecture and seek to make a considered response to the specific and unique conditions that are presented by each project.

Each Director brings a particular approach to their work, however it proves to be a very complementary assemblage due to the collaborative skills of all the partners. Underpinning the collaboration is a mutual commitment to produce architecture that is responsive and compelling. After almost 20 years together the refined combination of the three partner's talents supplemented by a strong, ambitious team provides iredale pedersen hook architects with a unique depth.

We are able to offer the full range of 'traditional' architectural practice services in project feasibility, design, documentation and project management and procurement. However we are increasingly also engaged to prepare masterplans, investigate spatial strategies, provide consultant services on building performance in remote or extreme environments and to advise on the translation of aspects of Indigenous Culture into contemporary building typologies.

The studio is active across a wide range of building types, client groups, user groups, community organisations, Government policy in relation to the built environment and infrastructure and architectural education. The diversity of our clients has enabled us to develop a consistent methodology of inclusive consultation where we acknowledge the valuable contribution of other industry professionals, stakeholders and user groups.

iredale pedersen hook have significant experience in working in the Australian public, community and Government sector. We are on the WA Department of Finance, Building Management and Works (BMW) Architectural Services Panel for complex projects in the Education, Health, Justice and General Building Categories and regularly receive direct commissions from this panel for buildings in urban, regional and remote areas.

We have developed the necessary systems and processes that are required to operate successfully in this context and our ongoing commissions demonstrate a high level of satisfaction in the services we provide by both BMW and their Agency Clients. We also have a long and fruitful relationship with the WA Housing Authority.

We would be pleased to provide referees for completed projects on request.



Kununurra Courthouse. With TAG Architects

DESIGN EXCELLENCE

Our ambition for design excellence is most effectively demonstrated through our consistent recognition in National and International Architecture Award programs and the ongoing presence of our projects in the global architecture media.

Over the past 20 years iredale pedersen hook have won over 150 awards for our projects, our work has been exhibited in Tokyo, Berlin, Seoul, Moscow, Toronto, New York and London, and we have been selected to represent Australia on numerous occasions at the pinnacle of international architecture exhibitions; The Venice Biennale.

The awards the studio receives are a rich mixture of 'Peer Review' through the Australian Institute of Architects AIA, Global awards programs such as the World Architecture Festival and peoples choice or consumer/user voting.

Our design work continues to be published internationally in significant architectural magazines including A+U (Japan), The Architectural Review (UK), Abitare (Italy), Domus (Italy), Architecture Australia, and Habitus. We are also a constant feature on the world's most read architecture media blogs ArchDaily, Dezeen and ArchitectureAU. Adrian, Finn and Martyn are regularly invited to present the work of the studio at international and national conferences, symposiums and at Universities around the globe.

The Walumba Elders Centre has been particularly successful including recently being awarded 2017 American Architecture Prize in Healthcare Architecture, 2016 Architecture of Necessity award (Sweden), the AZ Awards for 'Social Good' (Canada), 2015 BPN National Sustainability Awards (Australia) "Best of the Best" and the 2015 World Architecture Festival (WAF) Health Award effectively declaring it the "best health building in the world".

Also West Kimberley Regional Prison won the 2013 National AIA David Oppenheim Award for Sustainable Architecture (with TAG Architects). And most recently our first major health project, the Fitzroy Crossing Renal Facility was presented with the 2017 international Dulux Grand Prix Colour Award and 2018 World Architecture Festival Color Award.

Of particular note, the Architecture of Necessity Award is an international triennial competition for sustainable community building. It is open to buildings or city and community planning projects of all sizes, especially concerning regenerating townships, upgrading of housing estates and projects which discourage abandoning the countryside, more flexible housing and where social issues are addressed. Winners of the award fulfill the manifesto of an 'Architecture of Necessity' that is, they are responsible, diligent, sustainable, just, and open.

COLLABORATION

Our experience in working across a broad range of project typologies with complex constraints and challenging briefs has enabled the studio to quickly realise the critical role that collaboration plays in the creation, development and procurement of responsive, cost effective and sustainable architectural design.

Our inherently collaborative approach understands the necessity for full stakeholder engagement, prefaces the act of listening are the first step in the design process and acknowledges the importance of all contributions from consultants, industry professionals, user group and community consultation.

The supportive leadership we bring to the interdisciplinary teams we create for each project facilitates consistent communication and sets a strong direction and clear objectives. We develop specific strategies to ensure we maintain a focus on staying within the Client's brief and budget without compromising design quality.

We enjoy working in dynamic environments particularly when they include working with artists, landscape architects, community partners and engaged client groups.

Our public buildings are an excellent demonstration of our capacity to lead an interdisciplinary team to highly successful outcomes.



DESIGN APPROACH

iredale pedersen hook approach each new project with fresh eyes, open ears and alert minds to create a significant and meaningful outcome each and every time.

Our breadth of experience across many building typologies in a diversity of context is a clear indication of the durability of our design approach such that we are able to achieve exceptional outcomes for our clients and the community. Our design approach is not fixed nor methodological, it adapts to the sensitivities of each project and is agile in its process.

Every project is led by a nominated Director throughout the duration of the project who is fully accountable for the delivery of the scope of services under the contract. We ensure that there is design and management continuity through the whole design and procurement process with clear and open communication and effective decision documentation.

Our Design Review Process (DRP) enables participation of the consultant team at regular intervals to ensure important decisions have the benefit of their collective knowledge and experience.

A second IPH Director is actively involved in the project to ensure quality through insightful design critique and assessment against the design intent and development of project parameters.

Our commercial and public projects are all driven by 5 core design principles;

A “Whole of Team” Partnership

We ensure that the Client, stakeholders, occupants, and specialist sub-disciplines work together as an effective team and share the same understanding of goals and outcomes for the project.

We enjoy working in dynamic environments particularly when they include working with artists, landscape architects, community partners and engaged client groups.

An understanding of local context

Through careful observation and research we seek to understand local patterns of living and working, the micro-climate, and ideas of site from this study we are able to respond to the often diverse needs of end users, visitors and communities as a whole.

Sensible and Appropriate Sustainability

Through incorporating and implementing environmentally sustainable design principles as an integral part of the building fabric, we ensure that each project maintains its ESD capabilities throughout their life cycle, and can continue to provide comfort to the users, and minimal environmental impact.

To this end we utilise 3D solar modelling techniques and life-cycle costing tools that assist in the life-cycle analysis and

subsequently the cost benefit analysis of a material or system in a building. We are able to respond to the particulars of place and their impact on the design solution.

Buildability

We listen to local trades and builders and work closely with them to ensure at the outset that our design decisions and documentation are compatible with locally available trade skills and available materials. We programme the works and interrogate construction sequencing to ensure consistency with project milestones.

Enduring and Appropriate Design

Our projects seek to engage with the local context through material and built form but also how they respond to existing situations, patterns of use and impact of climate.

We design our projects to be flexible and adaptable with the knowledge that requirements may change and the architecture should be robust enough to accommodate new occupants or altered conditions.

Through the application of these 5 core principles we see clear and transparent objectives emerge through the Design process that allow the client to be a present, effective contributor to the resolution and ultimate delivery of an outstanding piece of architecture or community infrastructure.



Walumba Elders Centre, Warmun

SUSTAINABILITY

iredale pedersen hook has built a reputation for delivering projects with a focus of triple-bottom-line sustainable design - that is, environmental, social and economic sustainability.

We promote sensible and appropriate sustainability by incorporating and implementing environmentally sustainable design as an integral part of the building fabric. With a core focus on climate appropriate design, the studio ensures that each project maintains ESD capabilities throughout its life cycle, and can continue to provide comfort to the users, and minimise any environmental impact.

Over the past decade we have developed a national reputation for economical and appropriate sustainable design that have been recognised through winning multiple international and national awards.

These include being awarded the 2016 winner of the Architecture of Necessity Award in Sweden (for Walumba Elders Centre) as well as Australia's most prestigious sustainable design award, the National Australia Institute of Architects (AIA) 2013 David Oppenheim Award for Sustainable Architecture (West Kimberley Regional Prison with TAG Architects) and the National 2015 BPN "Best of the Best" National Sustainability Award, and the "multi-Residential" Sustainability Award (again for Walumba Elders Centre).

The jury citation for the Walumba Elders Centre demonstrates our core concerns;

"Here is a building which does all of the important things really well and is the epitome of sustainability. Not only does it sit comfortably in its environment with a very appropriate climatic design response, it is clearly responsive to the often complex cultural requirements of its user. Furthermore, that this project was delivered on a very tight budget to a remote location is testament to the designers understanding of the triple bottom line of sustainability for which they must be commended....if this is 'Aged Care', you would be happy to grow old in a home like this."

Our expertise in this area is reflected by the fact that Director Finn Pedersen has been invited to be a technical member for Western Australia of the Australian Building Codes Board for the Residential Summer Energy Performance review of the Energy requirement in the NCC-Building Code of Australia – focusing on the performance of these requirements on buildings in the tropics and sub-tropics.

Finn participated in the Department of Finance, Building Management and Works review of condensation in public buildings and contributed to the practical measures implemented by the BMW new guidelines on this issue. Finn is a co-founding member of Environs Kimberley Inc, a Broome-

based environmental group promoting landscape preservation and sustainable development in the Kimberley region of Western Australia. He has also undergone GBCA Greenstar Training.

A consistent approach to sustainable design is a critical part of our design process and includes investigation into the following: Micro-climate Analysis, Energy usage and production, Indoor Environmental Quality, Water collection, use and recycling, Material source, durability and embodied energy, Life Cycle Cost Analysis, Waste Minimisation, Future Proofing, Energy Efficiency Options, maintenance awareness and management.

These systems and areas are identified in a Sustainability Framework Plan that initially outlines the opportunities for a sustainable response to the core areas of sustainable design and our nominated Quantity Surveyor will provide indicative costs for such options as a normal part of our process. The client group and design team will then refine the list and track key features through the design stages of the project.

Our team is committed to exceeding expectations in regard to the implementation of sustainability principles without compromising the functional or budgetary requirements of the project.





Yagan Square is a new major public space that seeks to be a place for people to meet, discover and celebrate Perth and Western Australia's culture, heritage and environment. Situated on reclaimed land from the sinking of the railway line, adjacent to Perth Station, the project negotiates major transport infrastructure to provide a new set of community spaces, a market, bars and restaurants for locals, commuters and tourism. Yagan was a local Aboriginal warrior and the project draws on many narratives of indigenous and non-indigenous people to build the character of the place through ideas representing West Australian landscape, geology and culture. Elements of public art, play, water and planting all serve to engage the public with a new type of civic space that responds to the rich diversity of the City and the State.

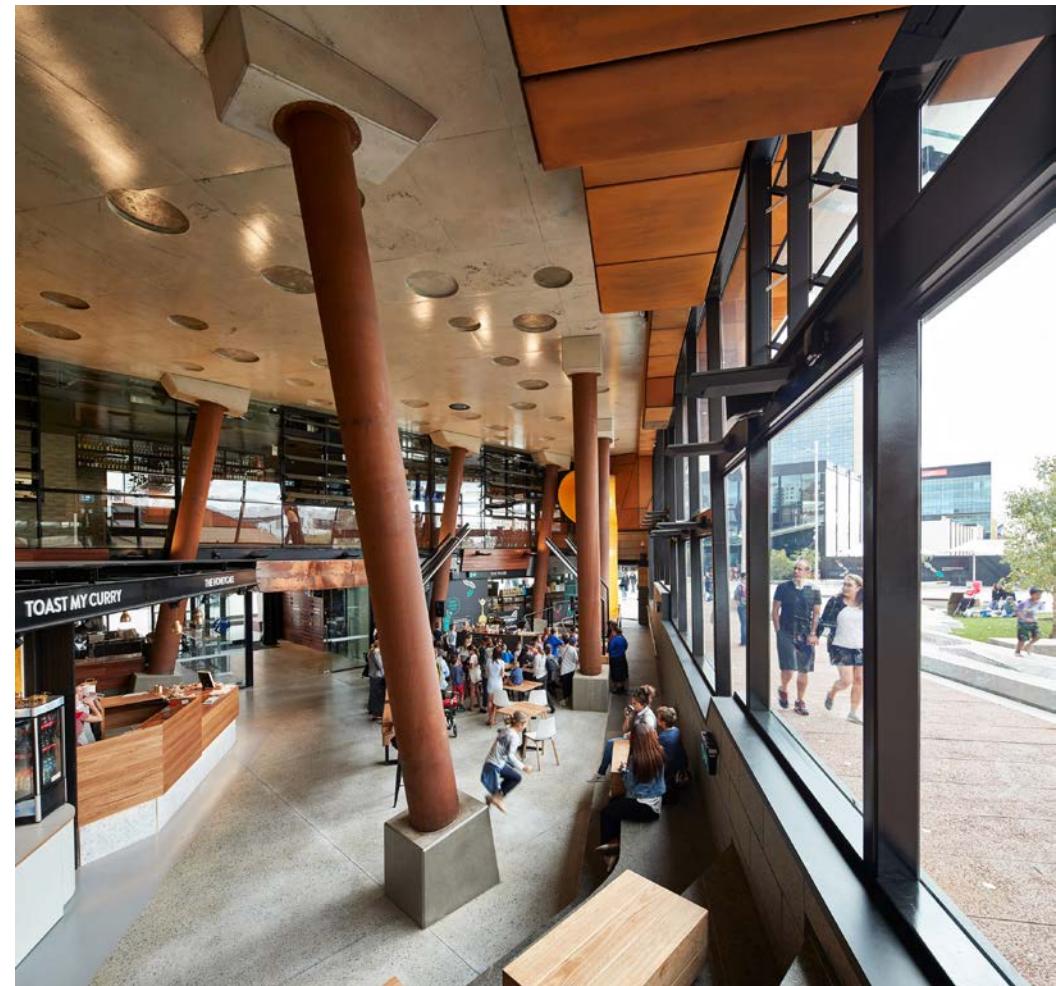





The remote town of Warmun was devastated by a catastrophic flood event displacing 300 of the local Gija people for a year. Some of the first buildings to be rebuilt were the primary school and the 'aged care facility'. Working directly with the community elders IPH evolved the brief for the aged care centre to design a new home for the elders based on their cultural and social needs, while still complying with the requirements the Commonwealth "flexible aged care provisions". The form of the building responds to the dramatic landscape of Warmun and is home for the residents and staff, provides a kitchen and laundry but also gender specific private activity areas and celebration areas for the community, wrapped around a courtyard. The courtyard serves as a sheltered gathering space but also a place for elders to pass on knowledge.







Kununurra Courthouse captures the uniqueness of the town's context, landscape and culture in a building that clearly reflects its civic role and importance in the local community. It re-interprets local physical qualities of site to respect the value of the regional courthouse as an important landmark building that will represent the presence of the local people and promote the role of the building as a centre for dispute resolution. The courthouse is designed as a culturally appropriate facility for Indigenous people, respectful of custom and lore that seeks to enrich their experience of the building regardless of the reason for their attendance. It also provides a Court environment that is spatially and psychologically accessible and amenable to Indigenous court users and is less intimidating to all.





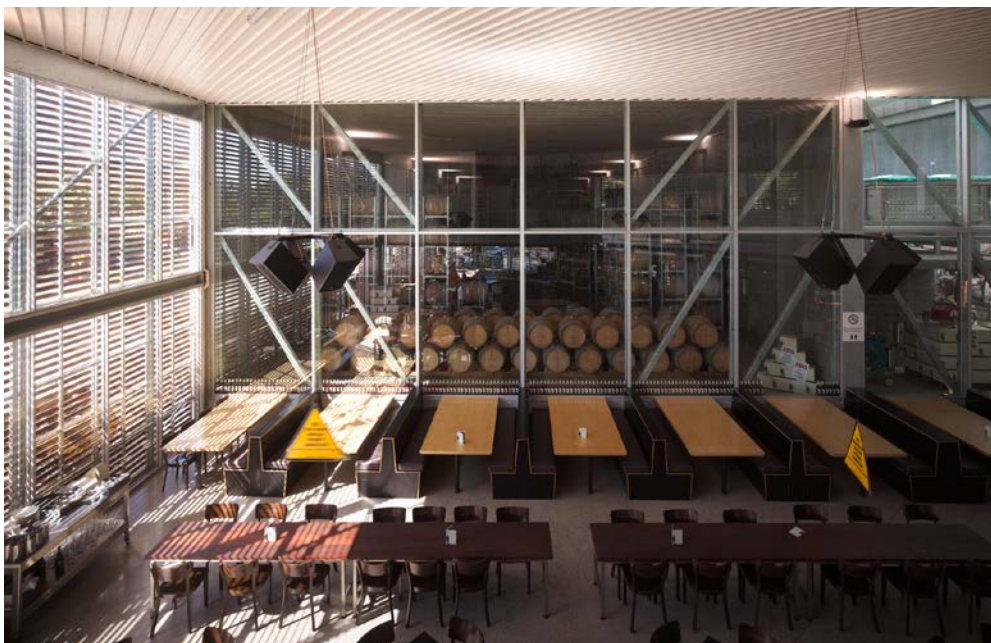

The Yarra Valley is an emerging wine region about an hour east of Melbourne, this new winery and cellar door complex is located in the main street of Healesville, the region's local centre. The architecture presents a strong formal gesture to the street that evolves a diagram of wine production (grape to bottle) translated into legible bands of activity. A long textured concrete wall the external face of the facility is both evocative and defensive forming a landmark and 'bookend' to the town. The climate controlled concrete box locks into a timber clad cellar door that upon entry seeks to reveal the complexity and alchemy of wine making through a massive wall of glass that provides a section through the barrel store and processing facility. The project celebrates the idea of a 'factory for food and wine making'.







This new building at an inner city Primary school provides an opportunity to explore the relationship between the School and the proximity of the city. Conceived as a small urban landscape the architecture assembles a collection of forms that define a sense of the city in scale and language, but does this in a way that is respectful to the adjacent heritage building by George Temple Poole. The project engages the street, creates an appropriate density in the suburb and addresses matters of identity and security for the children. The interior transforms a classroom into a device to explore the movement of sun through the day mapped in bright colours onto the ceiling and floor. The School now embraces the fundamentals of play in learning and a sense of citizenship that is responsive to the outdoor benefit of a generous Perth climate.





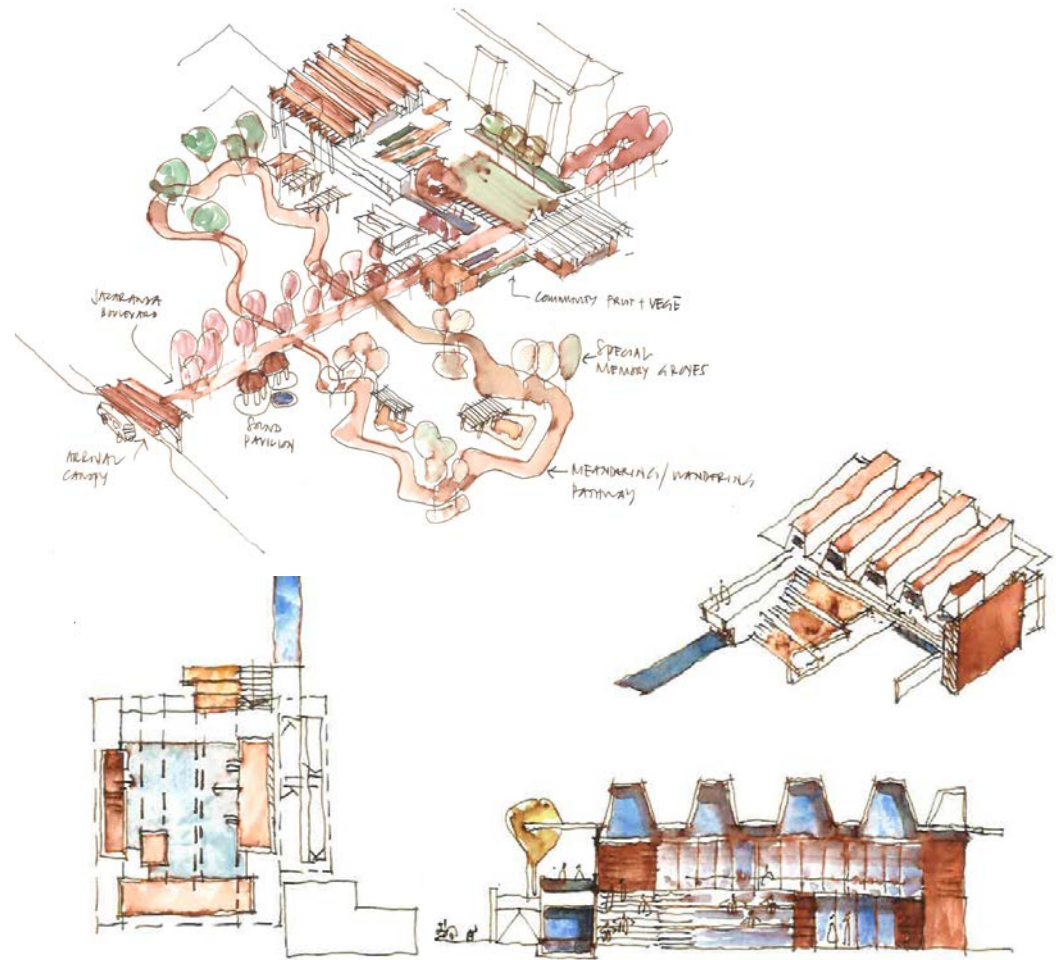

Located within the aged care facility of Swan Care Bentley Park Estate, IPH have designed a new masterplan for the site and a 'Leisure Precinct' including a new leisure centre, pool, refurbished bowling green, BBQ and picnic areas around a collection of pavilions for family and community events. Existing buildings are also refurbished to accommodate additional activity and provide a much-needed upgrade to the facilities. The masterplan seeks to create a physical environment that supports a broad interpretation of the meaning of retirement and responds to a diverse range of people, cultures, ages, health and fitness levels. The 'whole of site' response is driven by ideas of a community village focused on activity and sustainability, integrating new infrastructure with a generous landscape and a bias towards pedestrians.







In 2005 Kimberley Aboriginal Elders were asked to consult with their communities to determine what an appropriate prison might be for their people. The results of this ground-breaking report became our brief for the world's first culturally appropriate Indigenous prison. As a partnership between Government and Community the project is an exemplar in rethinking the nature of the facility, its operational management and the qualities of its masterplan and architecture. Essentially a unique community carefully woven into the existing landscape but contained by a high security fence, people live in houses in self-care, have access to education, training and rehabilitation programmes. Its purpose is to allow prisoners to have access to their families, Elders, Lore and Culture and to develop skills that allow them to re-engage on release.







Rivers are significant sites to Indigenous people throughout Australia, this project in the country town of Northam, east of Perth uses the Avon River as the key driver to its form and materiality. The building serves both as a community centre for the local Ballardong people and as a place to share knowledge about the local environment from the perspective of Aboriginal culture and country. The architecture responds to the dynamics of the landscape hovering above the floodplain and deflecting in plan to frame views up and down the river. The walkway elements lift visitors from the footpath elevating them from the ground, taking them on a journey in dialogue with the imagined path of the Wagyl rainbow serpent. The recycled timber screens lift and open to create dialogue with the existing buildings on the site and gesture to the community.

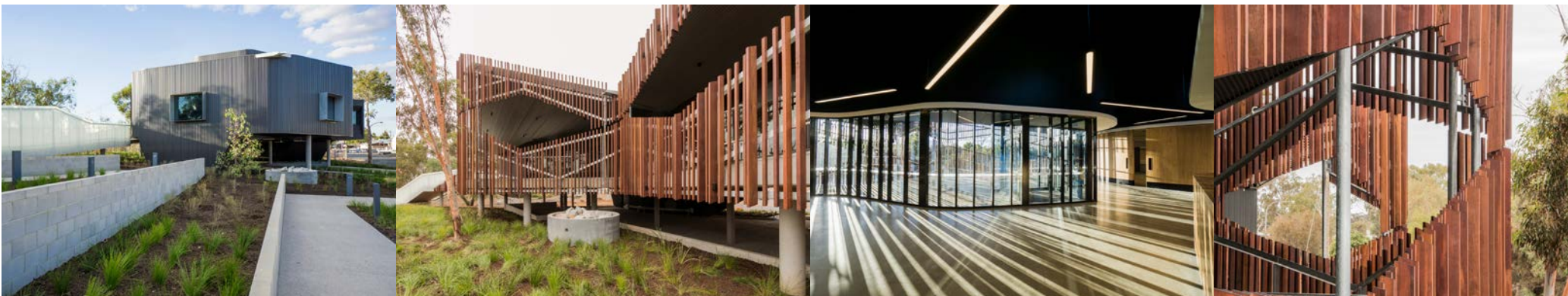





This facility provides accommodation for 20 renal patients and carers from outlying remote communities accessing renal dialysis, education, training and renal support services at the Fitzroy Crossing Hospital and the Ningilingarri Centre. A collection of 'twin unit' dwellings sit alongside a communal amenities building with a commercial kitchen, laundry and staff areas. These sustainable buildings are necessarily robust and low maintenance to deal with the desert conditions. Sited to maximise preservation of the existing landscape the buildings also draw on the rich colours of the surrounding flora and vegetation to inform a dynamic colour scheme. The design of the centre is sensitive to cultural constraints around gender and surveillance and also responds to local climate with shading fins, large overhangs and screened external verandahs.







This project forms part of the IPH studio's ongoing work for Perth Zoo. Designed to establish connections between Orang-utan behaviour, living patterns and qualities of their natural environment this new enclosure consists of a series of 'trees' that simulate the physical complexities of a rainforest. This is achieved through a careful assemblage of recycled concrete pylons and robust steel 'branches' and climbing frames. Each tree holds double decker nests with timber and steel shading structures providing points of rest. This, along with a collection of activities; puzzle boxes, dip tubes, water canoes, drinkers, the bent steel armatures and ropes are able to be tuned to create a constantly changing, stimulating environment.

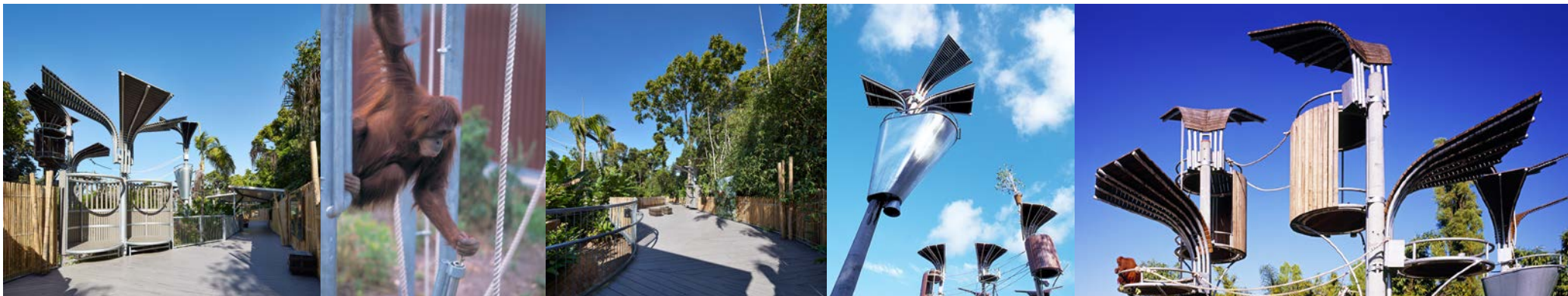



Yagan Square, Perth City Link. With Lyons Architects

MANAGEMENT METHODOLOGY

The key to providing a successful outcome for any project is to ensure that an appropriate proven and effective design and project delivery methodology is utilised.

We strongly believe that successful projects can only be produced in a context of teamwork, where appropriate skills and resources are matched to managed outcomes and goal fulfilment.

The development of our 'Design and Construction Management System' (DCM) is tailored to suit the particular requirements of each project.

The site and client specific application of our DCM allows flexibility in the formation and management of the team, the provision of inclusive client and user consultation, and the development of effective design strategies and a contract administration approach to suit the Client or Agency's particular needs.

Our approach to the successful formation and leadership of an interdisciplinary team has proven effective during the West Kimberley Regional Prison, Kununurra Replacement Courthouse (both in association with TAG Architects), Walumba Elders Centre and the Warmun Rejuvenation Project, the Roebourne and Kununurra Children and Family Centres and community

housing projects in the Kimberley, Pilbara and Goldfields. This management strategy has also been employed for recent projects including Yagan Square (in association with Lyons and Aspect Studio), Kings Square and Elizabeth Quay Food and Beverage Outlet 05.

Our DCM methodology recognises a holistic concept of a Total Project Team. The following actions will be performed (these specifically relating to leadership of an interdisciplinary team):

Multi-skilled Project Team Environment

We will create a multi skilled project team environment. Through this diverse team including Engineers, Code Consultants and Cost Consultants and other key stakeholders, we will collate, discuss and research the key issues related to this project, and develop clear Project Roles and Responsibilities in accordance with the Total Project Team.

The establishment of clear and effective communications channels and a feedback loop is fundamental to our approach.

Early formation including Cost Planner

Formation and integration of the Consultant Team - including the cost planners at an early stage in the project is critical to a successful outcome.

Director-led Projects

Each project is led by a Director of iredale

pedersen hook throughout the project's duration and, as such, all decisions have the benefit of their collective experience. Furthermore the lead Director is fully accountable for the delivery of the scope of services under contract and will be directly working on the project. A second Director is actively involved in the project often in the role of 'peer review' and can step in as required.

Structured Design Process

Our design team adopts a structured methodology comprising of systematic research, analysis, design modelling and reviewing/testing the design against the functional and operational briefs. This structure allows the Total Project Team to review each phase of the project development and provide feedback to the design team.

Effective Coordination of Consultants

iredale pedersen hook have established an industry reputation for providing our clients with comprehensive and thorough contract documentation and specifications for construction.

Management and coordination of the respective Consultants documentation is a key part of successful procurement and we believe that a thorough approach to design and detail resolution during both the design development and documentation phases results in a better quality built product with

reduced cost overruns and clear visibility of potential challenges in time and cost.

Tender Documentation

Production of concise yet thorough documentation for tender to produce the most favourable tender result. Structured leadership of the project team produces construction / contract documentation ensures that variations during the construction period are kept to an absolute minimum. During the construction stage of the project there are significant risks to manage to ensure cost and time are not compromised.

We pride ourselves on a reputation for 'on time and on budget', sensible and calm procurement of all our projects.

ORGANISATIONAL CAPACITY

The iredale pedersen hook studio structure is driven by a small and effective team formed to produce high quality services on complex projects.

Our structure and scale ensures that the Directors remain consistently involved with the project from commencement to completion and their direct leadership allows client and stakeholders a continuous point of contact at the highest level of seniority within the company.

iredale pedersen hook currently employs 15 staff, 13 of which are architects and graduates of architecture directly involved in day to day running of various projects within the office.

Led in Perth by Directors Adrian Iredale and Finn Pedersen, and with design and strategy input from Melbourne based Director Martyn Hook, the office is run using a 'flat' organisational structure whereby all team members are encouraged to actively participate and contribute at various stages of each project as it evolves in the studio.

iredale pedersen hook architects is a licensed architectural corporation and registered business that is fully insured for Professional Indemnity, Public and Products Liability and Workers Compensation.

The Director in charge of each project will be intimately involved with all aspects of a project throughout all stages and remains a constant presence and direct contact.

In support of the project our team has Senior Architects who are registered and able to perform the role of Project Architect and that have the experience and capacity to lead and manage the team, in addition to the ability to service consultants and address client groups.

We also have a range of experienced design and documentation staff who have been with the studio for some years and have been involved in projects of a variety of scales.

Each role is to be undertaken by the nominated personnel for the duration of the project. If staff are unable to fulfil their roles due to unforeseen circumstances, the studio possesses the personnel and capacity to replace with staff of equal standing.

The scale of our studio gives us the ability to service each project in a careful and attentive manner but we retain a depth of experience and connectivity that allows our collaborations to be as ambitious and aspirational as our clients and collaborators.

Recent Published Works

2016 Walumba Elders Centre, 'Senior Community Landscape', Tianjin Ifeng Space Media Co. Ltd China.
2016 Walumba Elders Centre, Appeal for and Architecture of Necessity p124-127 Virerums Konsthall, Kyrkogatan Sweden
2015 iph 2x Masters and PhD- The Pink Book- By Practice, By Invitation, Design Practice Research in Architecture and Design at RMIT, 1986-2011 by Leon van Schaik and Anna Johnson, p96, onepointsixone Melbourne Victoria.
2015 Kununurra Courthouse- Life Spaces Live Work Connect, IDEA interior design excellence awards 2015, p228-229, Niche Media Victoria 2015.
2014 Jewel Cave Visitor Centre – 'Augmented Australia; Regenerating Lost Architecture 1914 - 2014' Leon Van Schaik, p94 – 97, Australian Institute of Architects, ACT,
2014 'Architectural Urbanism: Seoul/Melbourne', RMIT Design Hub: 2014 Program Guide, RMIT University, Melbourne, Australia, 2014
2014 West Kimberley Regional Prison - CLOG: Prisons, Edited by Kyle May, Julia van den Hout, Jacob Reidel, Jeffrey Franklin, Archie Lee Coates IV, p118 – 119, New York USA, 2014
2012 Our "Home-for-All" design ideas, plans and all, compiled by KISYN-no-Kai- Toyo Ito, Riken Yamamoto, Hiroshi Naito, Kengo Kuma, Kazuyo Sejima and Ito School for the Exhibition "Home-for-All" Sendai Mediatheque 29 July- 1 September 2011, published by Takashi Kishi 2012 Tokyo Japan.
2011The Encyclopedia of Australian Architecture edited by Philip Goad and Julie Willis, p354, Cambridge University Press New York 2011.
2010 Constructing Families + Remotely Sustainable- 2 x masters, 'The Practice of Practice 2,' Leon van Schaik, RMIT (forthcoming)
2010 7 Projects iph architects- A to Z Architecture Zone, p330-363, H K Rihan Int'l Culture Spread Limited, 2010 China
2009 Think Brick Competition Submission, Richard Weller, Boomtown 2050, University of Western Australia, Perth Australia.
2008 Abundant- Australian Pavilion 11th International Architecture Exhibition la Biennale di Venezia 2008, p86-87, Australian Institute of Architects, ACT.

Exhibitions, Competitions and Ideas Submissions:

2018 Judges- COEXIST: RETHINKING ZOOS, Barcelona Zoo May 2018.
2017 Lecture: Steel- From Context to Culture- the approach of iredale pedersen hook architects, Keynote Speaker Bluescope Indonesia Bondclub International Seminar, Muli International Hotel 28th November 2017.
2017 Exhibition: Kununurra Courthouse, Bluescope Indonesia Bondclub International Seminar, Muli International Hotel 28th November 2017.
2017 Project Presentations: Fitzroy Renal Hostel, Elizabeth Quay Gelato Kiosk, Falcon Beach House, World Architecture Festival Berlin Germany 15th-17th November 2017.
2017 Exhibitor: Malaysia Biennial 100YC: medina 2017 curated by Tom Kovac, November 2017 Malaysia.
2017 Lecture: Scharoun- A Twenty Year Reflection, iph studio session, Perth WA 7th September 2017.
2017 Lecture and Panel Discussion: Fremantle Dust: Questions of usefulness for art and architecture, Finn Pedersen with Alex Hamilton, Paul Uhlmann and Geoff Warn, Art Collective WA Cathedral Square Gallery 16th August 2017.
2017 Lecture, Panel Discussion, Symposium on Creative Practice, Design and Architecture Practice Research, Brisbane, 27-28 July 2017.
2017 Lecture and Panel discussion: "Home-for-All" Sendai Mediatheque, Innovation, Courtroom Design and Social Justice 5-7 July 2017, LA Trobe University Melbourne Australia.
2017 Starting Your Own Practice- lecture Australian Institute of Architects WA Chapter 27 February 2017.
2016 Judge- World Architecture Festival Health and Transportation Category, 16-18 November 2016 Berlin, Germany.
2016 Walumba Elders Centre and Kununurra Courthouse- Architecture of Necessity, exhibition and conference IO Casa, Riva del Garda Italy, 18th-20th November 2016.
2016 Lecture Think Brick Roadshow Australia 26 October 2017, Frasers Perth WA.
2016 Walumba Elders Centre- 'The City and the World'- The Chicago Athenaeum: Museum of Architecture and Design and The European Centre for

Recent Awards

2017 Fitzroy Crossing Renal Hostel- WINNER 2017 World Architecture Festival (WAF), Best Use of Colour Prize- Completed Buildings Category.
2017 Fitzroy Crossing Renal Hostel- Shortlisted 2017 World Architecture Festival (WAF), Health- Completed Buildings.
2017 Elizabeth Quay Gelato Kiosk- Shortlisted 2017 World Architecture Festival (WAF), Shopping- Completed Buildings Category.
2017 Elizabeth Quay Gelato Kiosk- Shortlisted 2017 World Architecture Festival (WAF), Best use of Colour Prize- Completed Buildings Category.
2017 Falcon Beach House- Shortlisted 2017 World Architecture Festival (WAF), House- Completed Buildings Category.
2017 Perth Zoological Gardens Orang-utan Exhibit and Boardwalk Experience- The American Architecture Prize; Winner in Landscape Architecture / Installations & structures
2017 Walumba Elders Centre- The American Architecture Prize- Winner in Healthcare Architecture
2017 CASA31_4 Room House- The American Architecture Prize- Winner in Interior Design / Houses Interior
2017 Nannup Holiday House- The American Architecture Prize- Honourable Mention in Residential
2017 Walumba Elders Centre- Shortlisted Zumtobel International Group Award 2017 shortlisted from 350 international projects.
2016 Applecross House- Winner 2016 Think Brick Awards Grand Prix, Australia.
2016 Applecross House- Winner 2016 Think Brick Horbury Hunt Awards, Australia.
2016 Walumba Elders Centre- Winner The International Architecture Award for 2016 from The Chicago Athenaeum: Museum of Architecture and Design and The European Centre for Architecture Art Design and Urban Studies.
2016 Walumba Elders Centre- Winner 2016 Architecture of Necessity, Sweden
2016 Walumba Elders Centre- Winner 2016 AZURE 2016 AZ AWARDS- Social Good category, Canada.
2016 Walumba Elders Centre- 2016 Architizer A+ Awards Health Care & Wellness Award.
2016 Walumba Elders Centre- 2016 Architizer A+

Awards Architecture + Community Award.

2015 Walumba Elders Centre- World Architecture Festival (WAF) 2015 Health Award, Singapore.
2015 Walumba Elders Centre- Winner 'Best of the Best' ,BPN 2015 Australian Sustainability Awards.
2015 Kununurra Courthouse- Winner The Julius Elischer Award for Interior Architecture, AIA WA Chapter. With TAG Architects
2015 Walumba Elders Centre- Honourable Mention The Plan Awards, Health Category 2015, Milan Italy.
2014 West Kimberley Regional Prison- International Architizer A+ Award 2014 Typology Institutional: Government and Municipal Buildings, Police and Fire Station Category, New York. With TAG Architects.
2014 Nannup Holiday House- Honourable Mention The Architectural Review (AR) 2014 House Award England.
2014 Nannup Holiday House- Shortlisted in the top 6 Houses in the World Architecture News (WAN) House of the Year 2014.
2014 Nannup Holiday House- AIA WA Chapter The Marshall Clifton Award for Residential Architecture.- Houses.
2014 CASA31_4 Room House- AIA WA Chapter Sustainable Architecture Award (with Caroline Di Costa Architect).
2013 West Kimberley Regional Prison- The David Oppenheim National Award for Sustainable Architecture, Australian Institute of Architects (AIA). With TAG Architects.
2013 West Kimberley Regional Prison- Public Architecture National Award, Australian Institute of Architects (AIA). With TAG Architects.
2013 West Kimberley Regional Prison- The Chicago Athenaeum: Museum of Architecture and Design and The European Centre for Architecture Art and Urban Studies- The International Architecture Award for 2013. With TAG Architects.
2013 West Kimberley Regional Prison- The Wallace Greenham Award for Sustainable Architecture, AIA Awards WA Chapter 2013.

Adrian Iredale

Over the past 25 years Adrian has made a significant and sustained contribution to the profession of architecture at a State and National level. His participation in AIA juries both as a member and Chair across Australia have maintained a high level of critical discourse and clear advocacy for the impact that quality architecture can have in our community.

Adrian's role as Creative Director of Think Brick and his contribution to the national Houses Award seek to push architecture discourse into the public realm and in addition his role as the inaugural Chair of the City of Vincent Design Advisory Panel bring this commitment to a very local level.

Adrian is a Design Architect in its purest form, clearly thinking through drawing to translate ideas into clear communication. Educated in Perth, Melbourne (MArch Research RMIT) and Frankfurt (Stadelschule) Adrian's experience in practice and his extensive travels provide him with a truly global perspective. He has specific experience in innovative, low cost, sustainable housing for both public and private clients. These projects have been highly rewarded and published and continue to set benchmarks for West Australian housing.

Finn Pedersen

Finn has an interest in technology, cultural change and society, and the way that geography effects change on the people and organisms inhabiting that terrain. Finn has practiced throughout Western Australia for 25 years working on a variety of projects including regional and remote housing and infrastructure projects for Aboriginal communities, socially sustainable public infrastructure in the Kimberley, Pilbara and Eastern Goldfields Regions of WA.

Finn is a co-founding member of Environs Kimberley, a Broome based environmental group promoting landscape preservation and sustainable development in the Kimberley region of Western Australia. He is Vice Chairperson of the Wyemando and Jimmy Pike Trusts which provide funds to assist Aboriginal Language and cultural preservation and art practice development.

He completed a Masters of Architecture by Research at RMIT University. Titled "Remotely Sustainable: Architecture of Necessity" his research explored the impact of effective design solutions for indigenous housing in the NW of Australia and set the groundwork for the extensive work that IPH have completed in this area.

Finn is regarded internationally for his expertise in sustainable and culturally appropriate design and Australian Aboriginal community consultation.

Martyn Hook

Martyn is based in the IPH Melbourne studio and is also Dean of the School of Architecture and Urban Design at RMIT University. In balancing these two roles he is a passionate advocate for a maintaining a strong and critical relationship between architectural practice and architectural education. He was the Founding Director of the RMIT PhD Program in Europe, PRS_EU, which gathers a collection of European based practitioners to engage in research through design practice and oversaw the expansion of this program in Asia.

Martyn has particular expertise in the implementation of strategic vision in creative practice and driving organisational change through the lens of an integrated scholarship model that links teaching and research and architectural practice. He has been involved in the procurement of learning spaces, buildings and infrastructure at RMIT for many years and sits on the Campus Design and Development Committee and multiple design and project control groups.

A respected critic and commentator Martyn has produced many articles and book chapters and has lectured internationally on Australian architecture including London, Tokyo, Bern, Vienna, Ghent, Aarhus, Rome, KL, Barcelona, the Bauhaus Dessau and Bangalore. He has been Guest Professor at Innsbruck and TUWien and a critic at the Bartlett UCL, UK and KU Leuven Brussels.

iredale pedersen hook staff

Caroline Di Costa_Senior Architect, BArch (Hons) Curtin University

Joel Fuller_Architect, BArch (Hons) University of Technology Sydney (UTS)

Peter Weiss_Senior Architect, BArch (Hons) University of Melbourne

Rebecca Angus_Senior Architectural Graduate, BArch Curtin University

Tom See-Hoo_Senior Architect, BArch (Hons) UWA

Mary Mc Aree_Architect, Diploma in Prof. Practice in Architecture (RIBA Part 3) Uni. of Westminster UK.

Jason Lenard_Architect, MArch Curtin

Kim Valas_Architect, MArch Curtin

Rebecca Hawkett_Graduate of Architecture, MArch UWA

Leo Showell_Graduate of Architecture, MArch UWA

Natas Porter - Tech Support Services, BSci ACSA (Apple)

Perth Studio [t] +61 8 9322 9750
Murray Mews 329-331 Murray Street
Perth 6000

www.iredalepedersenhook.com
email@iredalepedersenhook.com

